

Microwave Motion Sensor (Uni-directional) HR50-Uni

Instruction Manual HOTRON LTD.

The HR50-UNI is a high performance motion detection sensor specifically designed for the activation of automatic doors. For the safe and accurate use of this product, please read this instruction manual carefully.



1 Technical Specifications

Power Supply: DC 12-30V, AC 12-24V
Current Consumption: < 1.4W
Product Size: 120mm x 70mm x 41.5mm (W x L x H)
Capacity of contact: 1A/24VDC
Microwave Module: 24.125GHz
Max Install Height: 4.0m
Hold Time: 1.2 Sec.
Operating Temp/Humidity: -20°C~60°C/0~90%
Detecting Field: 5m x 3m (W x D) (Height 2.2m)
International Protection: IP54

2 General Information

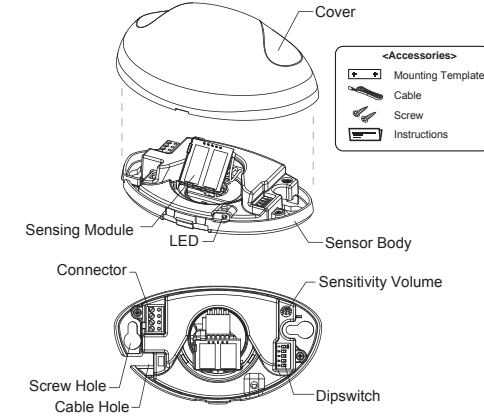

3 Installation Guide

Do not supply power during installation. Do not disassemble or modify the device, it may cause fire or electric shock.

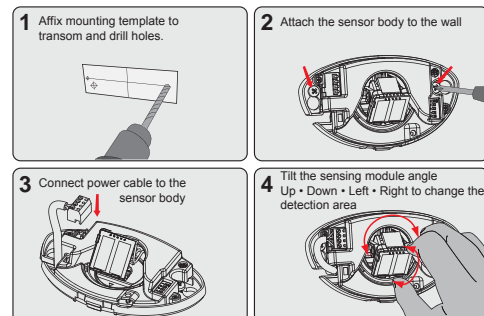

4 Sensitivity Adjustment

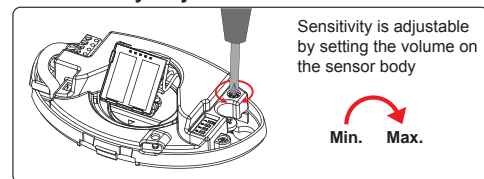

5 Wiring Diagram

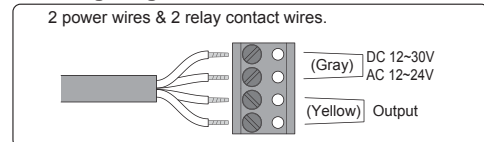

6 Mounting Information

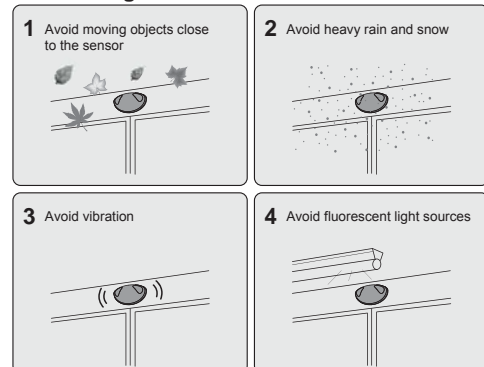

NOTE The specifications of this product can be changed without prior notice
 Hotron Ltd. 26 Dublin Street, Carlow, Ireland

CE 2150 FC U.S. Canada FCC ID: UXS2 IC: 6902A-UXS2

7 Detection Area Position Adjustment

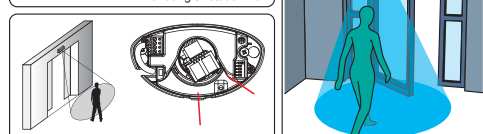
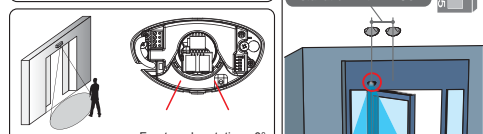
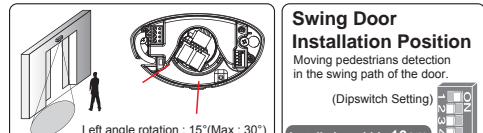
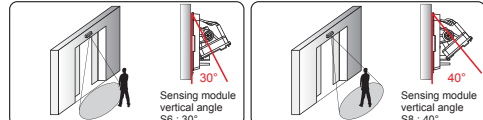

8 Wide or Narrow Detection Area Adjustment

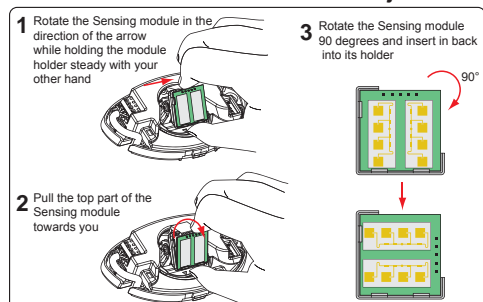

9 Detection Field (Mounting Height : 2.2m)

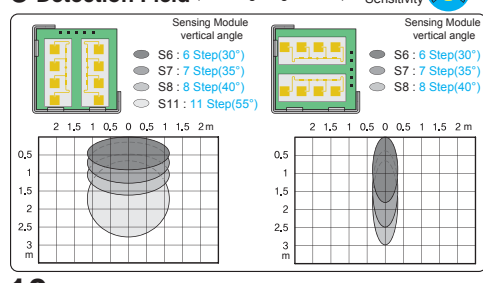

10 Dipswitch Setting (Default Dipswitch Setting NO. : 2)

NO.	Dip Switch	Direction	Turtle Mode	NO.	Dip Switch	Direction	Turtle Mode
1	NO	Up	NO	5	NO	Down	NO
2	NO	Left	NO	6	NO	Right	NO
3	NO	Up	NO	7	NO	Down	NO
4	NO	Left	NO	8	NO	Right	NO
9	NO	Up	NO				
10	NO	Left	NO				
11	NO	Up	NO				

Turtle mode (slow speed detecting mode) | Relay holding time 1 unit is 1 second

11 Weather Cover (Sold Separately)



Tel: +353 (0)59 914 0345 Fax: +353 (0)59 914 0543 www.hotron.com

Sensore di movimento Microonde (Monodirezionale) HR50-Uni

Manuale di istruzioni HOTRON LTD.

HR50-UNI è un sensore di rilevamento di movimento ad elevate prestazioni progettato specificamente per l'attivazione delle porte automatiche. Per un uso sicuro e corretto del prodotto, si prega di leggere attentamente il presente manuale di istruzioni.



1 Specifiche tecniche

Alimentazione elettrica: 12-30 V CC, 12-24 V CA
Consumo di potenza: < 1.4 W
Dimensioni del prodotto: 120 mm x 70 mm x 41.5 mm (Larg. x Lung. x Alz.)
Capacità di contatto: 1 A/24 V CC
Modulo microonde: 24,125 GHz
Altezza di installazione max.: 4,0 m
Tempo di mantenimento: 1,2 sec.
Temperatura/umidità di esercizio: -20°C~60°C/0~90%
Campo di rilevamento: 5 m x 3 m (Larg. x Prof.) (Altezza 2,2 m)
Protezione internazionale: IP54

2 Informazioni generali

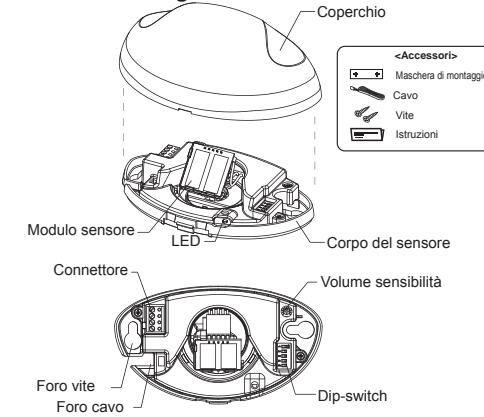

3 Guida all'installazione

Non collegare all'alimentazione elettrica durante l'installazione. Non smontare o modificare il dispositivo, potrebbe causare incendi o scariche elettriche.

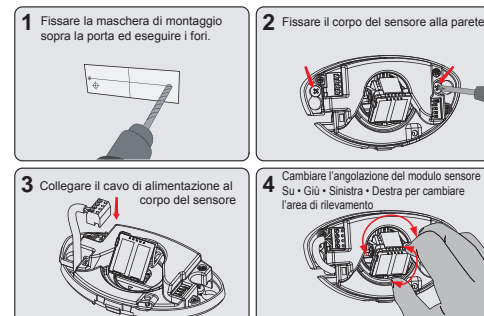

4 Regolazione della sensibilità

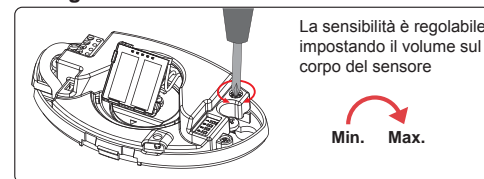

5 Schema di cablaggio

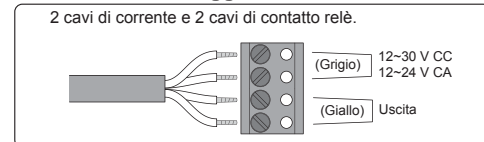

6 Informazioni di montaggio

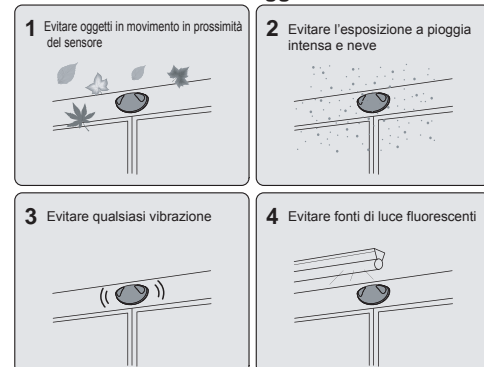

NOTE Le specifiche di questo prodotto possono essere cambiate senza preavviso
 Hotron Ltd. 26 Dublin Street, Carlow, Irlanda

CE 2150 FC U.S. Canada FCC ID: UXS2 IC: 6902A-UXS2

7 Regolazione della posizione dell'area di rilevamento

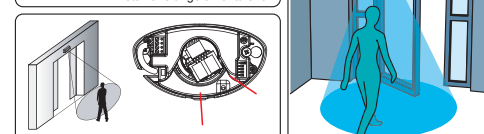
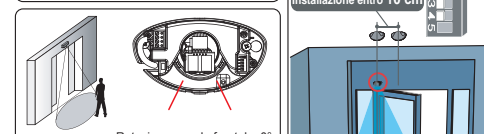
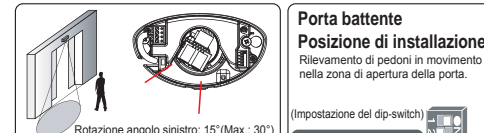
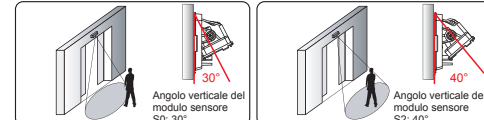

8 Regolazione dell'area di rilevamento larga o stretta

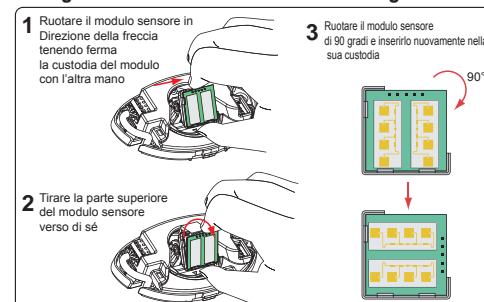

9 Campo di rilevamento (Altezza di montaggio: 2.2 m)

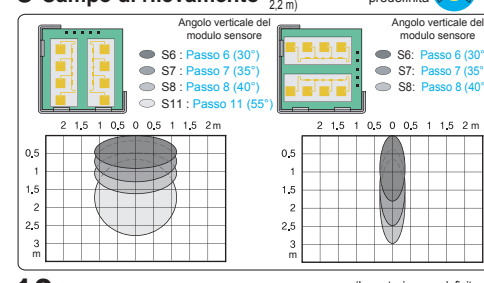

10 Impostazione del dip-switch (Impostazione predefinita del dip-switch NO. : 2)

NO.	Dip-switch	Direzione	Modalità "tartaruga"	NO.	Dip-switch	Direzione	Modalità "tartaruga"
1	NO	Up	NO	5	NO	Down	NO
2	NO	Left	NO	6	NO	Right	NO
3	NO	Up	NO	7	NO	Down	NO
4	NO	Left	NO	8	NO	Right	NO
9	NO	Up	NO				
10	NO	Left	NO				
11	NO	Up	NO				

Modalità "tartaruga" (modalità di rilevamento a bassa velocità) | Tempo di mantenimento relè 1 unità corrisponde a 1 secondo

11 Copertura anti-temperie (Venduta separatamente)



Tel: +353 (0)59 914 0345 Fax: +353 (0)59 914 0543 www.hotron.com

Sensor de movimiento por microondas (Unidireccional) HR50-Uni

Manual de instrucciones HOTRON LTD.

El HR50-Uni es un sensor de detección de movimiento de alto rendimiento diseñado para la activación de puertas automáticas. Lea detenidamente este manual de instrucciones para utilizar el producto de manera correcta y segura.



1 Especificaciones técnicas

Alimentación eléctrica: 12-30 V CC, 12-24 V CA
Consumo de energía: < 1.4 W
Dimensiones: 120 mm x 70 mm x 41.5 mm del producto: (Ancho x Largo x Alto)
Capacidad de contacto: 1A/24V CC
Módulo microondas: 24,125 GHz
Alteza máxima de instalación: 4,0 m
Tempo de espera: 1,2 s
Temp./Humedad de funcionamiento: -20 °C~60 °C/0~90%
Campo de detección: 5 m x 3 m (Ancho x Distancia) (Alteza 2,2 m)
Grado de protección: IP54

2 Información general

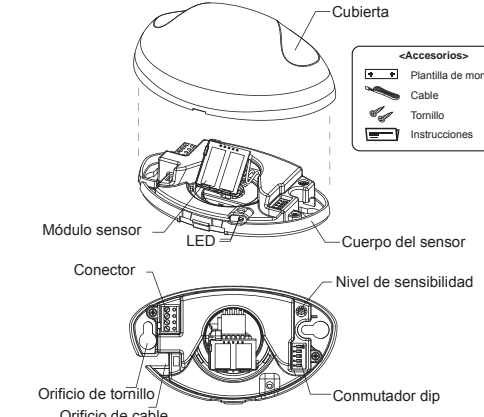

3 Guía de instalación

Desconecte el suministro eléctrico durante la instalación. No desmonte ni modifique el dispositivo, ya que podría incendiarse o provocar descargas eléctricas.

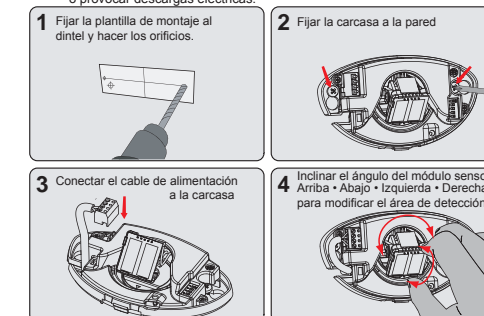

4 Ajuste de sensibilidad

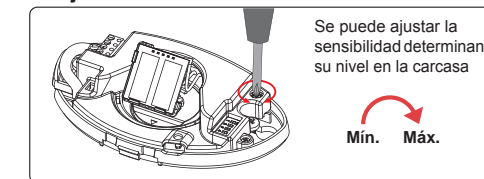

5 Diagrama de cableado

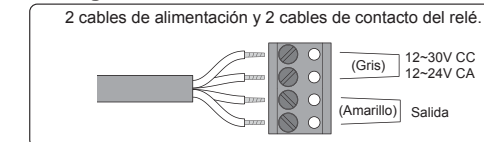

6 Información de montaje



NOTE Las especificaciones de este producto pueden sufrir modificaciones sin previo aviso
 Hotron Ltd. 26 Dublin Street, Carlow, Irlanda Tel: +353 (0)59 914 0345 Fax: +353 (0)59 914 0543 www.hotron.com

CE 2150 FC U.S. Canada FCC ID: UXS2 IC: 6902A-UXS2

7 Ajuste de la posición del área de detección

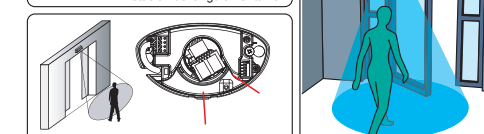
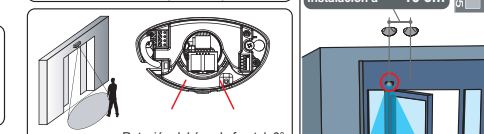
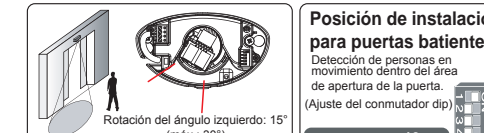
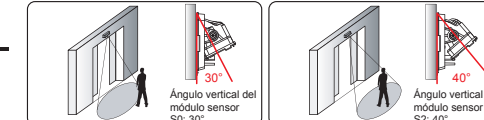

8 Ajuste de la anchura del área de detección

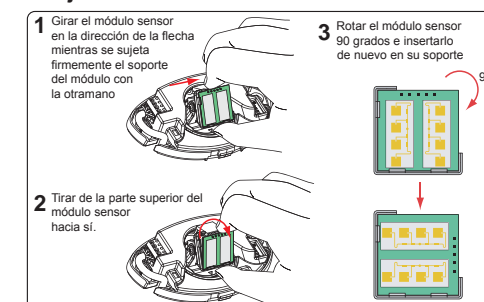

9 Campo de detección (altura de montaje: 2.2 m)

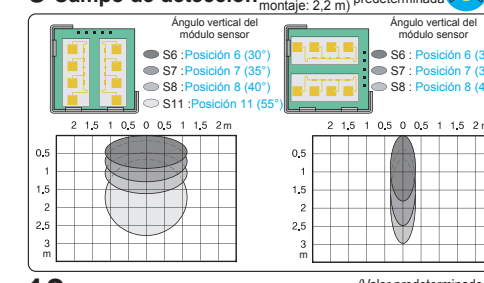

10 Ajustes del conmutador dip (Valor predeterminado del interruptor dip NA. : 2)

N.º	Conmutador	Dirección	Modo tortuga	N.º	Conmutador	Dirección	Modo tortuga
1	NO	Up	NO	5	NO	Down	NO
2	NO	Left	NO	6	NO	Right	NO
3	NO	Up	NO	7	NO	Down	NO
4	NO	Left	NO	8	NO	Right	NO
9	NO	Up	NO				
10	NO	Left	NO				
11	NO	Up	NO				

Modo tortuga (modo de detección de velocidad lenta) | Tiempo de espera del relé 1 unidad es 1 segundo

11 Tapa de protección (se vende por separado)



Tel: +353 (0)59 914 0345 Fax: +353 (0)59 914 0543 www.hotron.com

Détecteur de mouvement

Haute Fréquence (Uni-directionnel) HR50-Uni

Manuel d'utilisation HOTRON LTD.

Le HR50-UNI est un détecteur de mouvement haute performance spécifiquement conçu pour l'activation des portes automatiques.
Pour que ce produit fonctionne de façon sûre et correcte, veuillez lire ce manuel d'utilisation attentivement.



1 Spécifications techniques

Alimentation électrique : CC 12-30V, CA 12-24V
Dimensions : 120mm x 70mm x 41,5mm
Module hyperfréquence : 24,125GHz
Temps de maintien : 1,2 Sec.
Champ de détection : 5 m x 3 m (L x P) (Hauteur 2,2 m)

Consommation électrique : < 1,4 W
Puissance contact : 1A / 24VDC
Hauteur d'install. max. : 4,0 m
Température / Humidité : -20°C-60°C / 0-90%
Protection internationale : IP54

2 Informations générales

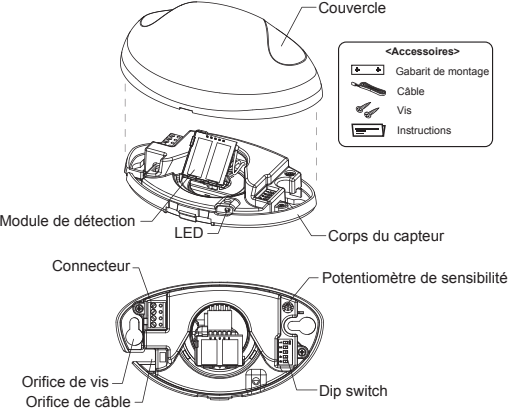

3 Guide d'installation

⚠ L'alimentation doit être éteinte durant l'installation. Ne pas démonter ou modifier l'appareil, cela peut entraîner un feu ou un choc électrique

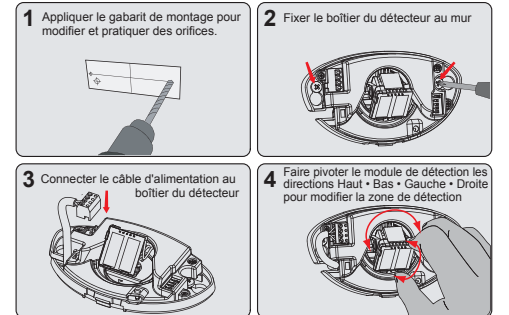

4 Réglage de la sensibilité

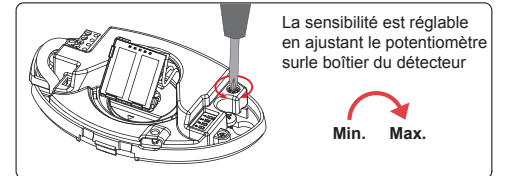

5 Schéma de câblage

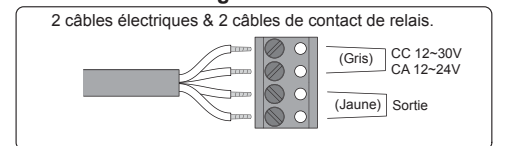

6 Informations de montage

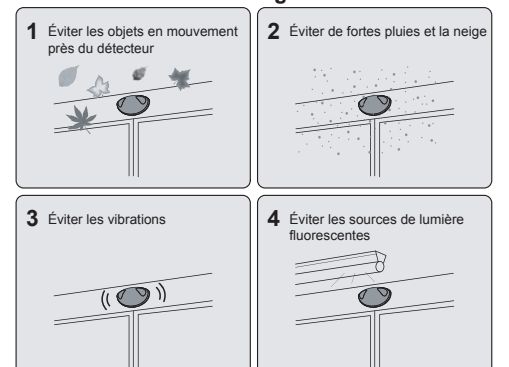

⚠ Les spécifications de ce produit peuvent être modifiées sans information préalable

7 Ajustement de la position de la zone de détection

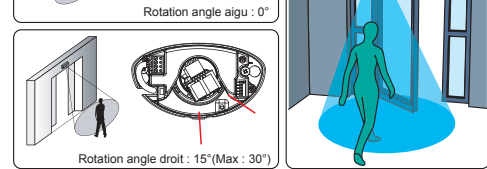
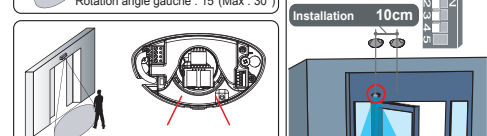
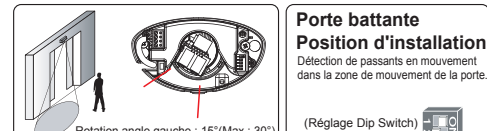
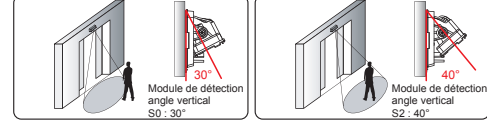

8 Ajustement de la zone de détection pour large ou étroite

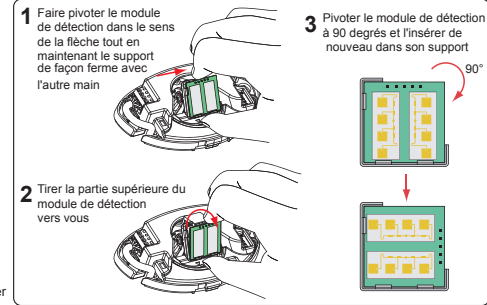

9 Champ de détection (Hauteur de montage : 2,2m) par défaut

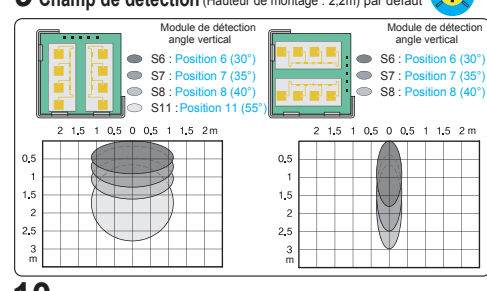

10 Réglage Dip switch (Réglage Dip Switch par défaut No. : 2)

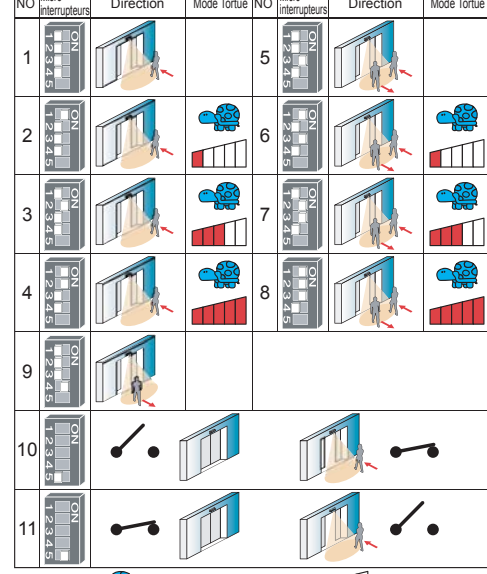

11 Protection contre les intempéries (Vendue séparément)



Mikrowellen

Bewegungssensor (Richtungsempfindlich) HR50-Uni

Betriebsanleitung HOTRON LTD.

Der HR50-UNI ist ein leistungsstarker Bewegungssensor, der speziell für die Aktivierung von Automatik Türen entworfen wurde.
Für einen sicheren und korrekten Gebrauch des Produktes lesen Sie bitte sorgfältig diese Betriebsanleitung.



1 Technische Daten

Stromversorgung : DC 12-30 V, AC 12-24 V
Produktabmessungen : 120 mm x 70 mm x 41,5 mm
Mikrowellenmodul : 24,125 GHz
Haltezeit : 1,2 Sek.
Erfassungsbereich : 5 m x 3 m (B x T) (Höhe 2,2 m)

Leistungsaufnahme : < 1,4 W
Kontaktkapazität : 1A/24VDC
Max. Einbauhöhe : 4,0 m
Temp./Feuchtigk. Betrieb : -20°C-60°C/0-90%
Schutzklasse : IP54

2 Allgemeine Informationen

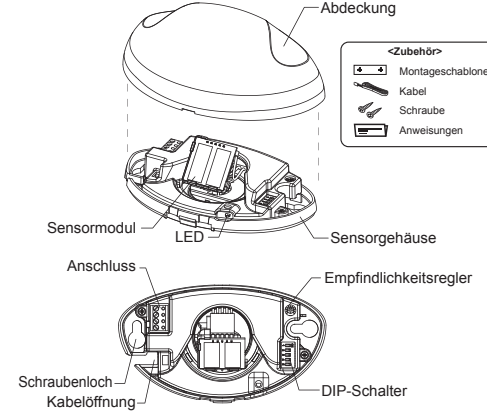

3 Installationsanleitung

⚠ Während der Montage darf kein Strom anliegen. Das Gerät darf nicht verändert oder zerlegt werden, da sonst Brand- oder Stromschlaggefahr besteht.

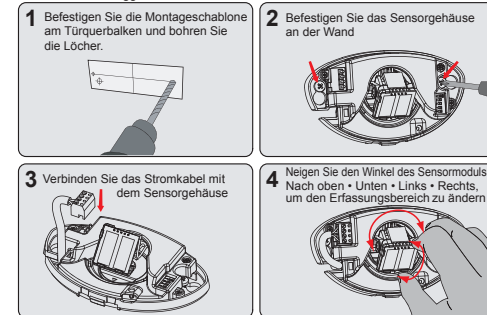

4 Empfindlichkeitseinstellung

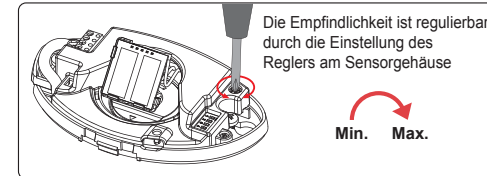

5 Anschlussplan

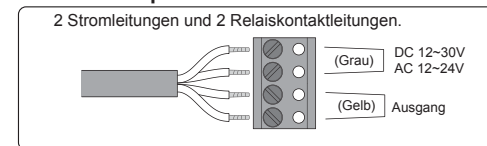

6 Informationen zur Montage

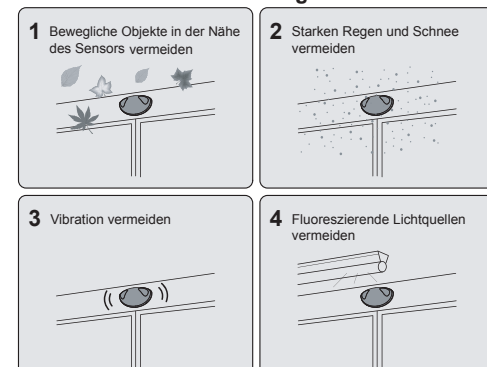

⚠ Die Produktspezifikationen können ohne Vorankündigung geändert werden

7 Einstellung des Erfassungsbereichs

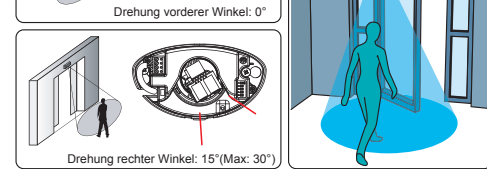
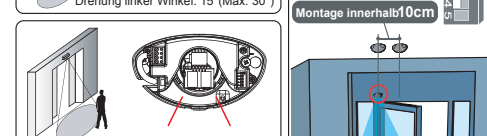
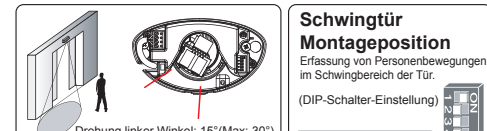
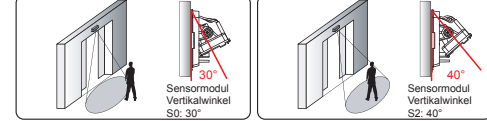

8 Einstellung eines breiten oder schmalen Erfassungsbereichs

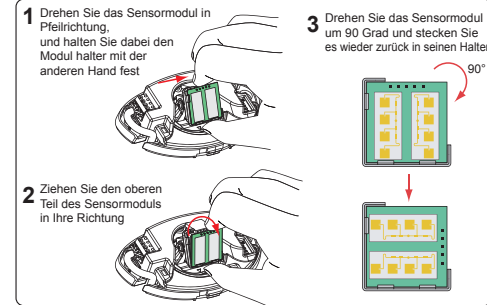

9 Erfassungsbereich (Montagehöhe: 2,2 m) Standardeinstellung

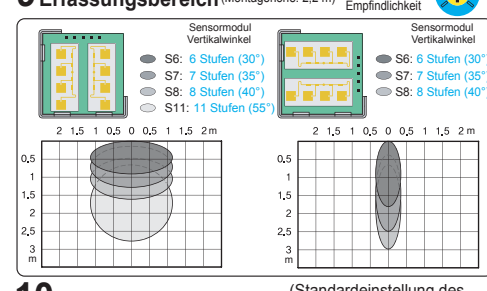

10 DIP-Schalter-Einstellung (Standardeinstellung des DIP-Schalters ist Nr. : 2)

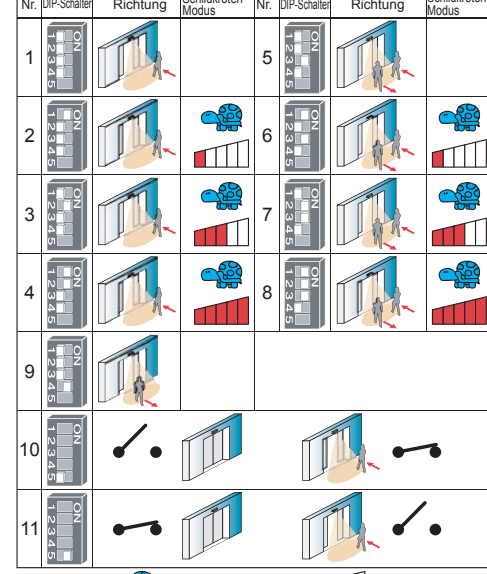

11 Wetterschutz (separat erhältlich)



Mikrodalga

Hareket Sensörü (Tek yönlü) HR50-Uni

Kullanma Kılavuzu HOTRON LTD.

HR50-UNI otomatik kapıların aktivasyonu için özel olarak tasarlanmış yüksek performanslı hareket algılama sensörüdür.
Ürünün güvenli ve doğru kullanımı için lütfen bu kullanma kılavuzunu dikkatli bir şekilde okuyunuz.



1 Teknik Özellikler

Güç Kaynağı : DC 12-30V, AC 12-24V
Ürün Ebadı : 120mm x 70mm x 41,5mm (G x B x Y)
Mikrodalga Modülü : 24,125 GHz
Tutma Süresi : 1,2 Sn.
Teşpit Alanı : 5 m x 3 m (G x D) (Yükseklik 2,2m)

Güç Tüketimi : < 1,4 W
Kontakt Kapasitesi : 1A/24VDC
Maks. Kurulum Yüksekliği : 4,0 m
Çalışma Sıcaklığı/Nem : -20°C-60°C/0-90
Uluslararası Koruma : IP54

2 Genel Bilgiler

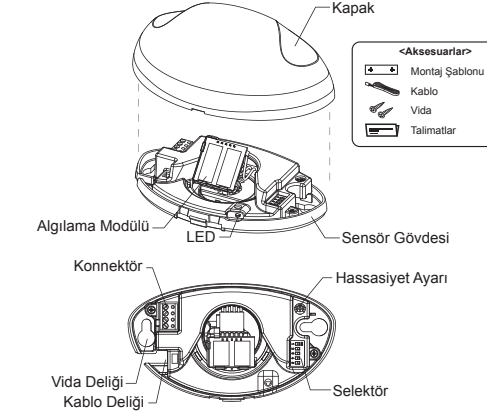

3 Kurulum Kılavuzu

⚠ Kurulum esnasında güç beslemeyiniz. Cihazı demonte etmeyiniz veya değiştirmeyiniz, yangın veya elektrik çarpmasına neden olabilir

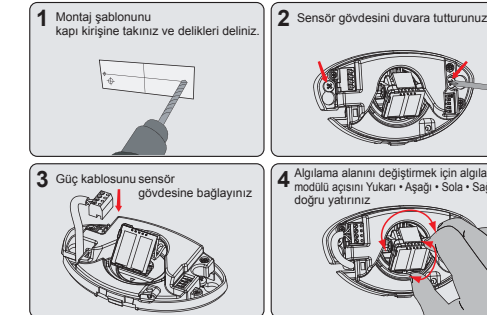

4 Hassasiyet Ayarı

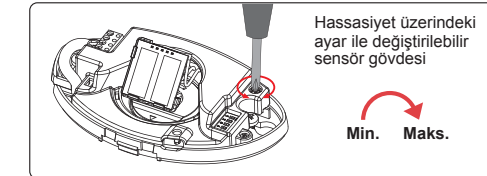

5 Elektrik Şeması

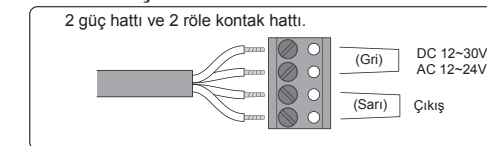

6 Montaj Bilgileri

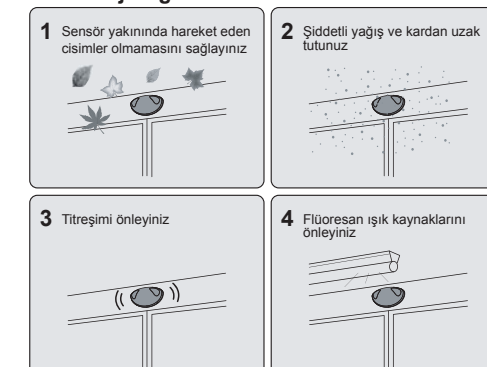

⚠ Ürün özellikleri önceden haber vermesiz değiştirilebilir

7 Algılama Alanı Pozisyon Ayarı

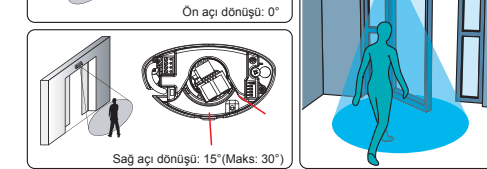
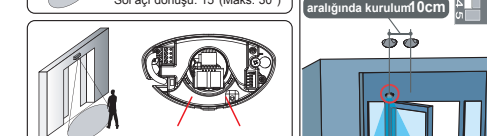
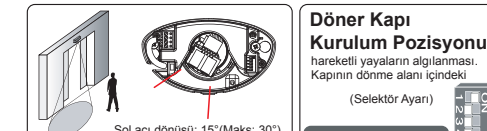
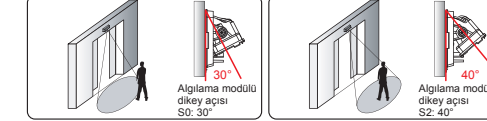

8 Geniş veya Dar Algılama Alanı Ayarı

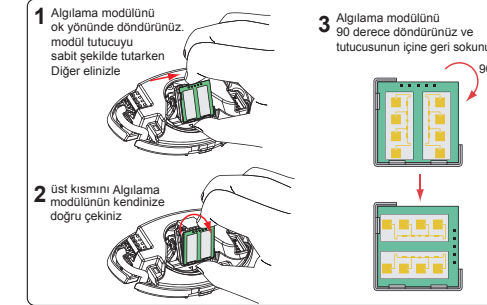

9 Algılama Alanı (Montaj Yüksekliği: 2,2m) Varsayılan Hassasiyet

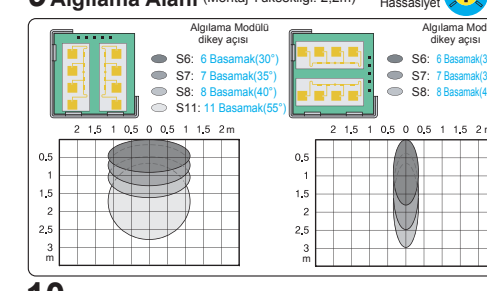

10 Selektör Ayarı (Varsayılan Selektör Ayarı NO. : 2)

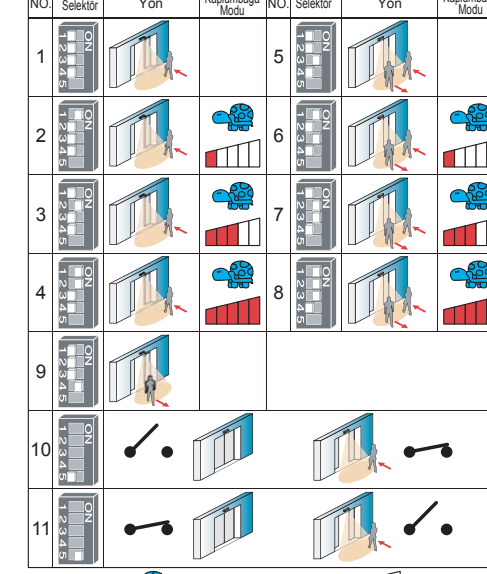

11 Hava Kapağı (Ayrıca Satılır)

